



# The 3905 Century Club Telegraph

## October 2021

A 3905 Century Club Monthly Newsletter

### In this issue:

- Welcome
- HandiHam Buro
- Dean's Notes
- Ben's Column
- ARRL in Action
- Good Net Practices
- Top Band Antennas
- October Contests
- Events/Special Nets
- Road Trips
- Clubs on the Move
- Classifieds
- PTOA Event
- NetLogger Feature

## Welcome!

Welcome to the October 2021 issue of the 3905 Century Club Telegraph.

Fall is here and hopefully the noise on the bands will start to quiet down. For whatever reason, the band conditions on the 20 meter nets this summer have been poor. Despite this, the 20m Net Control Stations hung in there and did a great job. A tip of the Telegraph Hat to the 20m Net Control Stations!

We are always looking for article ideas and contributions. Please send articles or suggestion for articles to:

[k7qhu@outlook.com](mailto:k7qhu@outlook.com).



## HandiHam Bureau Information

Congratulations to Glenn Silver AE4EK, who was recently appointed as the Handiham QSL Bureau Manager. In the article following, Glenn gives us insight into how the Handiham QSL Bureau will operate.

### 3905 Century Club Handiham Bureau

**T**he purpose of the 3905 Handiham QSL Service is to provide a fast, convenient and inexpensive way for Handihams needing the services of a QSL Manager to fill out their reply cards when exchanging QSL cards for contacts made with other participants of The 3905 Century Club nets.

The use of this service is open to all Handihams needing QSL Manager services, and to all other net participants needing to send QSLs to Handihams who are using this service. The QSLs exchanged must only be for the confirmation of contacts made on nets operated by The 3905 Century Club. When checking in to 3905CC nets, Handihams who have made arrangements to use this bureau as their QSL Manager should state to the Net Control Station that they wish to exchange QSLs via the Handiham QSL Service.

### Logs:

I use Ham Radio Deluxe to manage logs files. Each Handiham has their own log file created using their call sign. Log files in ADIF format should be sent to the Handiham bureau weekly. This allows the bureau enough time to process the log and send outgoing cards. PLEASE filter the log files to include ONLY 3905 net contacts.

### Cards:

Two options are available for QSL cards. The best option is to send a supply of cards for yourself and any clubs or special events you use. Please try to limit the clubs and special events, the time required to process the cards may become overwhelming. Please keep the cards to the standard 3.5 x 5.5 size.

The second option for cards is to supply a JPEG file which will fit on a 3.5 x 5.5 card. Please keep the cards simple (single sided with MINIMAL graphics. I have light weight stock for cards going to the bureau and heavier stock for directs.

### Cost:

I prefer using Paypal for payment but will accept checks made out to me. Each Handiham account is maintained on a spreadsheet showing all transactions and current balance. I will send emails when balances get low. All postage is charged at the current rate. My current rate for printing simple cards is \$.05 each (subject to change for cost of supplies). Copies of the transaction spreadsheet are available on request.

### Where to send cards:

There are two ways to get cards to the Handiham bureau:

1. Direct to the bureau manager
2. Send to the regular bureau with your other cards and they will be forwarded to the Handiham bureau.

### Incoming cards and logs:

1. ADIF logs from each Handiham will be loaded to HRD when received
2. Incoming cards, direct or from the bureau, will be logged into HRD and filed. Cards received will be sent to the Handiham when they reach 2 ounces, every 2 weeks, or an agreed upon time period.

### Outgoing cards:

1. GIB cards will be sent to the 3905 bureau periodically (usually weekly unless there is a high volume).
2. Direct cards will be sent as soon as a log file has been processed.
3. All incoming cards (except those that are no card needed) will be validated in the Handiham's log. Those that match and have no reply sent will have cards created and the log updated to prevent duplicates.

### Mobile and portable operations:

**PLEASE** notify the Handiham bureau of any mobile or portable operation whether you are logging or not. Please supply dates and locations ( State(s), park names, etc). The accuracy of your cards is only as good as the information I have. If you are not logging, I will send out response cards but I will not log the calls in HRD.

### Handiham log files:

A Handiham can request a copy of their log file at any time. I will extract it to ADIF format and email it to them.

**Glenn Silver**

**AE4EK**

Handiham Bureau Manager

## Dean's Column

### Notes from the President

By Dean Davis, N7XG



**T**he time just seems to be going by at record pace. September has been a busy month. With

the board approving the pilot project we had less than a month to update the NCS guide. I am happy to report that this has been completed, a draft presented to the board, and towards the end of the month our Net Coordinators and NCS stations are doing the final review.

On another issue the IT Task Group has gotten restarted after most of the members took some advantage and took vacations. Seemed like since the Eyeball there was always one member on vacation. Anyway, we have re-started and look for more information in the committee report that will be submitted to the board.

Another item to be thinking about is elections will be starting soon and this year it will be for even numbered directors and president. So now is a good time to starting thinking about who you would like to see in one of these positions.

Dick Powell, WK1J started talking with me this past month about a YouTube video he had watched: <https://youtu.be/GLhNUmolKKY> regarding building a shortened 40, 80, and 160 inverted vee dipole antenna. For me this was exciting news since the antenna has 2 coils on it and is much shorter than a 160m dipole. Dick has also built and sent me this antenna and I will be testing it in October. What is really exciting about Dick's tri-band dipole is that it can be built with off the shelf parts and if you have room for an 80 antenna this one will fit into the same space. Anyone interested in the calculations you can email me using the email address on the club's website.



Did you know that during any round when you call a station marked as NEW in the remarks field, after that call is complete, you may make a second call to anyone else on the list. This applies to all rounds. Also, if you are working a new station, please welcome them to the net.

73,

Dean

## Ben's Column

### Notes from the Awards Secretary

By Ben Goldfarb, AE4NT



**S**ummer flew past in a great hurry, punctuated by a wonderful Eyeball gathering in Louisville, MS run by Kirk Frazier, AA1NA. The awards program has seen an uptick in the number of 100-Point Award applications, especially for digital modes and CW, which can be directly attributed to Kirk's efforts to run QRP nets in all modes during Eyeball Week.

My summer mobile trip was quite successful as well, as is evidenced by the huge piles of QSL cards I have received and have not yet had the time to log in and file. However, I earned a Clint Wise Mobile Award on 75 Meters SSB and upgraded my 40M SSB Clint Wise Mobile to Level 30, thanks to you and your contacts.

I've also received some Baker's Dozen Certificates of Appreciation.

All in all, I operated mobile in twelve states: Alabama, Mississippi, Arkansas, Missouri, Oklahoma, South Dakota, Minnesota, Iowa, Illinois, Pennsylvania, Virginia, and West Virginia. Band conditions were good throughout the trip.

## 45<sup>th</sup> Anniversary Award

The Awards Committee is working on a yearlong award to commemorate the Club's forty-fifth anniversary. We're trying to make it easy but challenging, which might mean we wind up with two related awards, as we did for the Club's thirtieth anniversary. We want to make sure it is uncomplicated and easy enough for everyone to have a chance to get an award, but we also want the overachievers to be challenged. After we have hammered out the details, we will submit the award(s) to the Board of Directors. We anticipate putting it on the agenda for the November meeting for implementation by February 7, our Club's anniversary date.

## Awards Manager Shopping

As of October 1, the Board of Directors has amended the bylaws to require that you *must* deal with the appointed area awards manager for the call area of your home QTH for all awards applications and associated functions. While most of us are doing this now, in the past there had been problems with the practice known as “awards manager shopping.” Each area director will deal with any issues members encounter with their awards manager and will work with the member to solve problems. Awards files, although primarily the responsibility of each member, will be maintained by the awards manager in each area for members in that area, which is necessary for their convenience in checking progressive and other awards.

In the unlikely event that an area awards manager is incapacitated or otherwise cannot perform his or her duties, it is the responsibility of the applicable area director to solve the problem effectively and timely. Their area director is each member’s primary point of contact for all administrative functions in his or her area.

## EV Challenges

Our road trip vehicle is about to celebrate its tenth birthday, so I felt the need to replace it. The ridiculous fuel prices we encountered inspired me to look at the electric vehicle (EV) market. As you know, both new and used car markets are ridiculous now as well, so after an interesting research period and lots of dealer QRM, I decided to order a Tesla Model Y.

My winter challenge will be to install my rig in this new vehicle, which is scheduled to be delivered sometime this month (October). Some of you know that I had put a lot of time into installing my Icom 7000 and Tarheel 400A in the old BMW X3. That vehicle is going to be sold, so I just spent considerable time removing the rig and its hidden wiring. Now, what lies ahead is not only hiding wiring, but figuring out how to run an AM radio in an EV – a sketchy near-impossibility evidenced by Tesla not including an AM broadcast radio in their vehicles.

Two significant sources of RFI will provide challenges. I will probably need to eschew operation while driving because the high-voltage electric motors and the inverters that provide AC for them will likely be a S9+20 dB noise source. I do most of my mobile operations from a stationary position for safety and so I can use NetLogger while I’m on our nets. However, there is still an issue. While the Tesla has an auxiliary 12-volt standard car battery to drive accessory circuits, it is charged by the big-ass battery, which requires a DC-DC converter, another QRN source. Besides, Tesla’s manual states, “Caution: Do not use the Battery as a stationary power source. Doing so voids the warranty.”

So, my thoughts are going to a second 12-volt battery like a Bioenno isolated from the car’s low voltage system. I’ll need the 12 volts at about 30 amps for the transceiver and another amp or so for the Tarheel’s motor and the TuneMatic controller. Charging this auxiliary battery without using the car’s systems will be yet another challenge.



If anyone has installed a rig in an EV, I'm all ears!

I hope to be able to plan next summer's trip to visit more states and work you from the Tesla, which I might name "Mission: Impossible".

Until next month, keep sending in those award applications and don't forget to thank your hard-working, eagle-eyed area awards manager for all the good work!

---

## ARRL in Action!

In the September Issue of the Telegraph, we ran an article (from WFTV, a Florida Television Station) concerning the possibility of a amateur radio station causing interference to a medical device. The ARRL has issued the following response:

### ARRL Responds to Story of Radio Amateur Told to Remove His Antenna

09/02/2021

ARRL has responded to an Orlando, Florida, news story on August 23, 2021 by WFTV Channel 9 alleging a radio amateur was told to remove his antenna by the management of his subdivision following a complaint made by a neighbor.

"The news story appears to stem from a 2-year-old complaint from a neighbor who believed her insulin pump had malfunctioned due to the radio amateur's operations 'a few doors down,'" said ARRL Laboratory Manager Ed Hare, W1RFI. "The story is lacking any details or timeline, so I contacted the radio amateur involved for information, and volunteered ARRL's assistance."

Hare explained that medical devices such as insulin pumps are regulated by the US Food & Drug Administration (FDA) specifically for electromagnetic compatibility (EMC) purposes and are expected to be capable of operating in all the RF environments likely to be encountered by consumers. FDA published guidance for its staff and industry defines EMC with respect to electrically powered medical devices "as the ability of a device to function safely and effectively in its intended electromagnetic environment, including immunity to electromagnetic disturbance (interference)." FDA review of EMC information submitted with a device for approval "is based on the risk associated with EMC malfunction or degradation of the device under review, as well as the use of appropriate FDA-recognized standards or appropriate consensus standards."

Hare noted there is an FDA recall for the model number of the insulin pump in question, in approximately the same time frame. "But with so few details, there is no way of knowing whether that recall applies to the serial number used or whether the exact unit has the mechanical defect indicated in the recall notice that could cause the malfunction," explained Hare.

It also became apparent that there is no actual evidence connecting the amateur's transmissions to operation of the insulin pump. Hare was told that the amateur agreed to run

tests to establish whether there was a cause and effect, but the neighbor declined. Hare commented, "While there are no requirements for a radio amateur to stop transmitting due to alleged interference to a non-radio device, the preferred path with any complaint is for neighbors to work together."

---

## Good Net Practices

Over the summer, our net procedures for check-ins and new stations have evolved. Marty Blaise AG5T has put together a list of good practices to consider when you check into our nets.

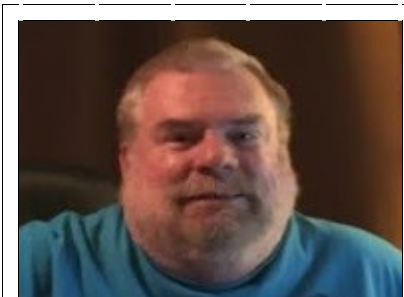

### Ways you can help the net run smoothly by Marty Blaise, AG5T

- NCS is the abbreviation for "Net Control Station".
- When checking out in Net Logger, use the AIM window – check out with your check in list number and your call sign. Something like *c/o #37 AG5T thanks for the net.*
- When net control calls for a relay, don't relay unless asked by NCS. Net Logger designates the relay stations in orange. NCS also announces designated relays.
- If you are a mobile station (without internet) and need to recheck or check out, do it over the air. NCS should never check out a mobile unless heard checking out.
- When conditions are rough, and you can't hear (or barely hear) NCS watch for the pink line.
- Sometimes a relay station will announce your turn, so be alert.
- If you want to get higher up on the list, check in early as a pre-list check in. (In reality, when you get your calls can change especially if many stations check out)
- If you are going to be away from the radio and will come back later, have the NCS mark you as (U) for unavailable.
- If possible, try to work the NEW stations. It makes them feel welcome and you get a second call. Remember you must work the NEW station first.
- Try to keep the AIM window comments related to the net. The NCS is monitoring this window, the main window, and the monitor window, so they have a lot going on.
- When a DX station is checked in, remember that the NCS must log all contacts between stations and the DX station, so allow the NCS a few seconds to do so.

When making a call, it's a good idea to say the number of who you are calling and the callsign. For example, "This is AG5T calling number eight K7QHU. Steve you are five by nine. Over". Keep it brief, especially if both are five by nine.

- Even if you think you've worked everyone, it's still okay to go up for grabs. Occasionally you will even get a call.
- Net control is your friend, but remember they are in charge and are doing a lot of things.
- Always tune up away from the net and if possible, use a dummy load.
- If the other station is weak, focus on the signal report and let the NCS give the call sign.
- Try not to cough, sneeze, or clear your throat into your microphone, especially if on VOX.
- Remember that this is a hobby, and it should be fun.

---

## Inverted L's and Loops for Top Band

by John Reisenauer, Jr. KL7JR



**1** 60 meters is a fun band and if you've never experienced it you owe it to yourself to try it! Most hams aren't on 160m because of space constraints. A quarter-wave on 160m is only about 120 feet long total. There are ways to shorten this length even further by using coils. Some of the below links illustrate this shortening method. A good ground system is required. By good I mean at least 2 radial legs at  $\frac{1}{4}$  WL and 4 or 6 more at various lengths (more is better but you eventually end up at the "land of no return". In

other words- no negligible difference gained. Some hams think they need hundreds of radials but that kind of overkill gains you very little in return. I usually use 6 to 8 ground radials and a ground rod and do just fine on all bands. An Inverted L, vertical or sloper should tune 160m thru 6m with minimal effort even using your rig's internal tuner as my old TS-570D does.

### Inverted L

My Inverted L, heavy duty for arctic use, was a killer on 40-160m and good on the other bands. I used the metal mast as my vertical riser up to a coil and then sloped back to earth. Some field trips I was able to get the sloping end up higher.



[KL7JR 160/80 Meter Inverted L For Arctic Use \(hamuniverse.com\)](http://hamuniverse.com)

## 160 meter inverted L cut for 1.900 MHz total wire length 124 feet

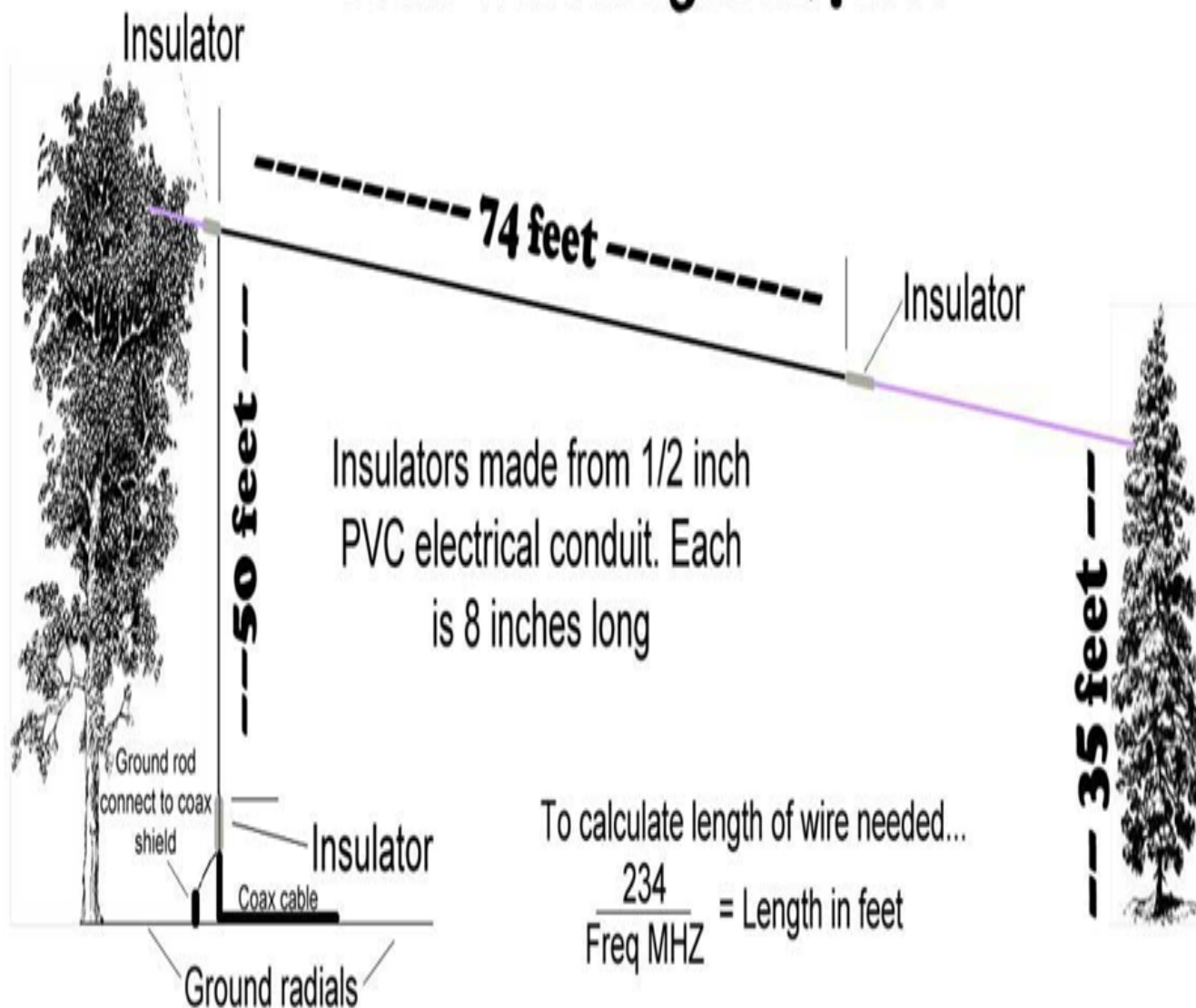

The basic 1/4 WL Inverted L can be designed for any band. Simple to build and install and economical on the pocket book are the key words in describing this wire antenna! I most always employ this antenna as a sloper for 75m when I am portable. Very seldom do I have the space on my portable outings for an 160m sloper, more or less an Inverted L. Both work well at modest heights too!

My other 160m antenna is a full wave Delta Loop (elongated) with horizontal polarization as in sketch below.

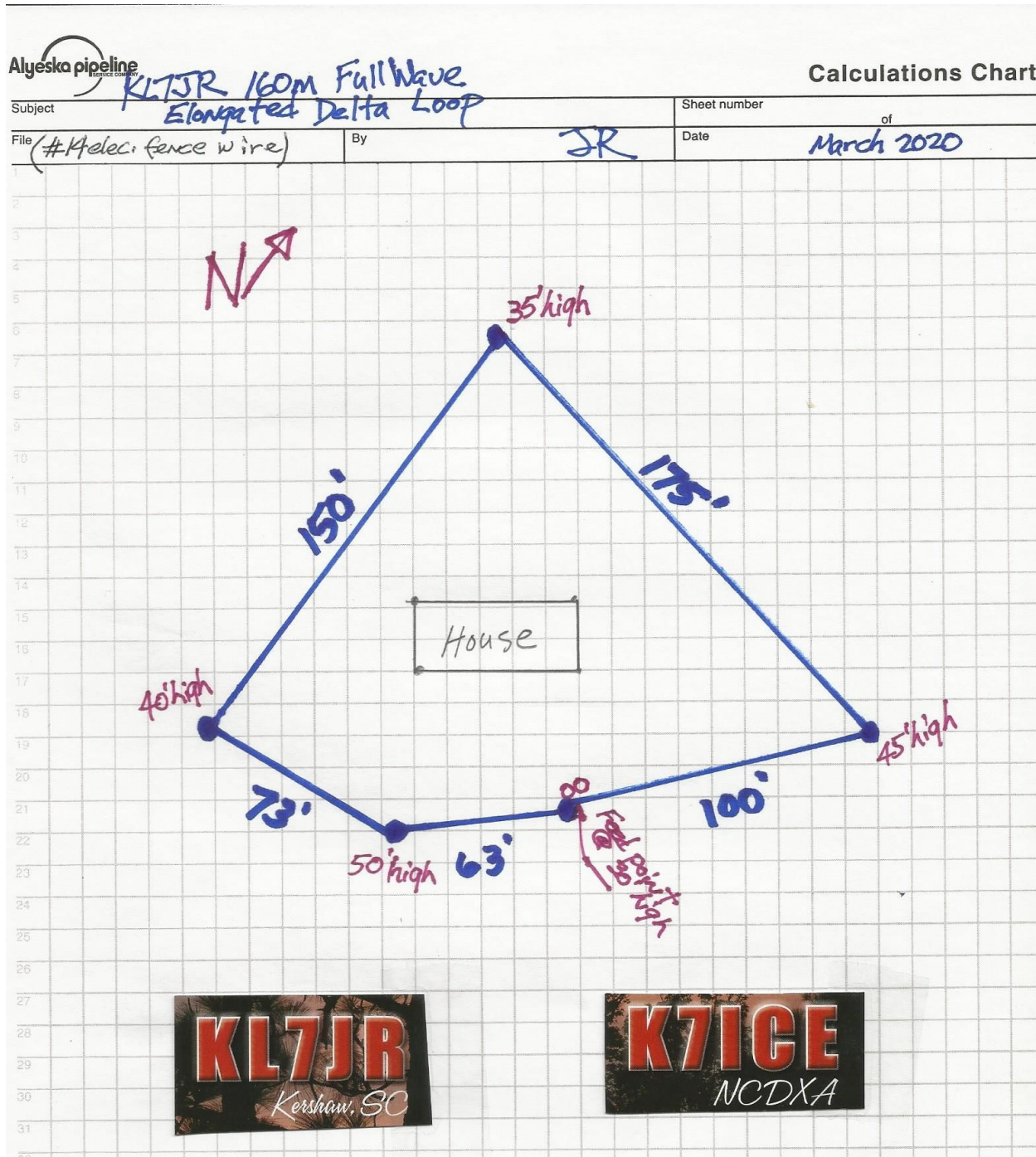

## Loops

If you have the space why not put up a loop? I've used many loops over the years and they are my antenna of choice. You can make yours rectangular, square or Delta (pyramid shaped) and horizontal or vertically polarized. A round loop is the best but who has all those supports, hi hi! I can't say enough good things about loops! A loop is basically a shorted dipole with the ends connected together. The links below are my most favorite loops besides the 160m full wave Delta loop I use now at my QTH. Before I retired from Alaska I used a  $\frac{3}{4}$  WL (on 20m) rectangular loop indoors from my 14<sup>th</sup> floor (top) apartment in Anchorage (Link 2). That's 140 feet above ground! Who wouldn't want to try an indoor antenna now, hi hi! I just thumb-tacked the loop to the living room wall and bedroom wall (yup, I drilled holes through the wall for the top and bottom legs!). I kid you not when I say I created pileups almost every time I got on 15, 17 and 20m with the occasional 10/12m opening. So, the moral of the story is you can use reduced size antennas but I wouldn't go less than 75% on the lowest band of operation. Link #3 below explains my  $\frac{3}{4}$  WL 20m loop from the Dominican Republic. Note my huge ground plane out front-my best friend Mr. Saltwater! I made several thousand contacts on 10-20m in 2011-2016.

It all started here.....

Link 1...1.25 WL 80m Horizontal Loop in Richland, WA

<https://www.hamuniverse.com/kl7jr80loop.html>

I just had to try this design....

Link 2...3/4WL 20m rectangular "Indoor Loop" used in Anchorage, AK

<https://www.hamuniverse.com/kl7jrindoorloop4010.html>

Hmmm, it worked well indoors, let's try it outdoors...

Link 3...3/4 WL 20m rectangular "outdoor" loop in the Dominican Republic

<https://www.hamuniverse.com/kl7jrstealth20meterloop.html>

73,

John KL7JR

## October 2021 Contests

Contests in October that could impact net operations:

TRC DX Contest : 0600Z, Oct 2 to 1800Z, Oct 3

JARTS WW RTTY Contest : 0000Z, Oct 16 to 2400Z, Oct 17

CQ Worldwide DX Contest, SSB : 0000Z, Oct 30 to 2359Z, Oct 31



---

## Upcoming Events and Special Nets in October, 2021

**Note:** Regular Board Meetings are always held on the second Saturday of each month, local time at 9PM Eastern, 8PM Central, 7PM Mountain, 6PM Pacific.

### Upcoming Events:

- 3905CCN Board Meeting: Saturday October 9, 2021.

### Special Nets:

What is a special net? A special net is planned by the Net Coordinator and the NCS. Examples of a special net might be:

All YL's checked in to the net get two calls on their turn.

All State Capitals checked in to the net get two calls on their turn.

All stations checked in to the net get as many calls as they can make in 90 seconds.

Any station checked in at a National Park gets two calls on their turn.

If you have a particular special net you would like have happen, contact the appropriate Net Coordinator.

**Note to Net Coordinators:** If you schedule a special net, please let the Telegraph know!

**No Special Nets have been submitted to the Telegraph this month.**

---



## Road Trips!

Yukon John has caught the National Park Fever! If you are trying for the National Parks Award, John will be providing a great opportunity to snag some National Park contacts! In September, John checked into the nets from Congaree National Park, S.C.



### John, KL7JR Great Smoky Mountains National Park.

KL7JR and KL7RST will be active Oct 1-7 from: Great Smoky Mountains National Park. Great Smoky Mountains National Park straddles the border between North Carolina and Tennessee. He will also be on from KY. Research indicates poor cell and internet service there. KL7RST/W4 is card requested.



### Claire, WZ9O Portable New York

"I have always found portable operations during my travels to be a challenge and now that Covid seems to be easing up, I have the opportunity to make more trips at my leisure and bring my ham radio along with me to operate portable. I would love to thank everybody who had the opportunity to work me when I activated the Colorado capital back in September. As I look towards October, I realized I have not seen my family since I moved to Wisconsin in early 2019. From October 15-19, I will be back at my family's home operating portable in New York, operating primarily on 40 and 75 SSB for their respective nets, outside of the day of the New York State QSO Party as I will be more focused on that activating Jefferson County in Upstate New York, close to the Canadian Border on October 16 from 1400z to 0200z October 17th. I look forward to operating any stations that I might come across as I return back to my original home as long as my family does not plan any special events during my time seeing them in almost 3 years."



## Club Stations/Special Event Stations on the Move!

If you are hosting a club station or special event station, this is the place to let members know!

**No notifications about hosting a club station or special event were received this month.**



## CLASSIFIED ADS

This section is for members who would like to sell, swap, or purchase ham gear. If you would like to list your equipment here, please send the information to [k7qhu@outlook.com](mailto:k7qhu@outlook.com). The deadline for ads is the 25th of the month.



---

### FREE FREE FREE!

I have for free to anyone that loves Old Mechanical Teletype Machines:

I have owned these units for over 40 years.

The model 28 ASR and Model 15 Both were rebuilt by me around 1979.

Model 15 KSR Complete. Needs servicing as has been stored for ages

Model 15 KSR Almost Complete for parts

Model 28 ASR Complete but without Receive Reperf. Needs Servicing

Paper Winder for Model 28 ASR

Model 28 KSR Almost Complete for parts.

Model TT-143/UG Transmitter Distributor

Paper Rolls

Paper Tape

Miscellaneous Parts

These need to go to a Teletype Lover. Not for Scrap Metal.

Pick up at my location.....Need Pickup Truck or Trailer.

Bring your strong back and a helper.

73,

Robert – W4RHB

## FOR SALE: Alpha 8410 Amp

Folks,

I have an Alpha 8410 amp for sale and am giving CCN members first dibs on the amp.

I purchased it new. Non Smoking environment. Works very well.



Asking \$3,700 Current retail on this amp is \$6,495

If interested please private mail to me at dean at [alpinsoft dot com](mailto:alpinsoft.com)

---

## For Our Members That Follow PTOA

### New England Parks On The Air Event Set for Mid-October

09/29/2021

The inaugural Autumn New England Parks On The Air (NE POTA) event will take place on Saturday, October 16, 0000 – 2359 UTC, the [K1USN Radio Club](#) has announced. The goal is to have one group or individual operator at as many [Parks On The Air®](#) as possible. The K1USN Radio Club hopes this will become an annual event. This is a recreational radio event, not a contest, so no logs will be required to participate. Summaries of activity are encouraged, however, and a [post-event link](#) will be available.

“This began as a reaction to the widespread local interest in the Parks On The Air (POTA) program here in New England. Last year, Ohio had a successful Ohio-wide POTA weekend, and Wisconsin is now doing something similar,” said K1USN Radio Club President Pi Pugh, K1RV. “Autumn is a special time in New England, and I figured the event might generate some extra interest before winter. Perhaps this can become an annual New England event or, better yet, an annual nationwide or worldwide event.”

ARRL New England Division Vice Director Phil Temples, K9HI, is hoping the event will give the public a chance to learn a bit more about amateur radio. He encouraged those who plan to participate to promote the event with informational handouts.

Jamboree-on-the-Air (JOTA), the largest Scouting event in the world, also occurs during the weekend of October 16 – 17, and NE POTA participants are being encouraged to reach out to local Scouting groups.

A [spreadsheet](#) has been created to keep track of individuals and clubs that register.

## A NetLogger Feature - The Custom Contacts Filter

**T**here may be some features in NetLogger that you are not aware of or have not tried. One useful feature that I have started to use is the “Custom Contacts Filter”. This feature can really be helpful when you are trying to gather contacts for an award. Lets take look at how to use it.

The “Custom Contacts Filter is located in the “Edit” drop down menu on the NetLogger home page. See Fig 1.

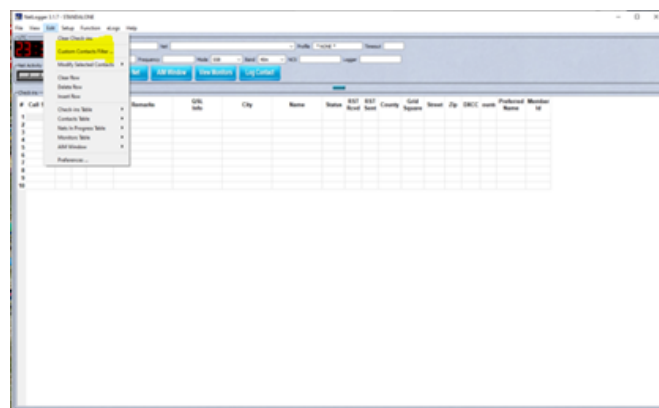
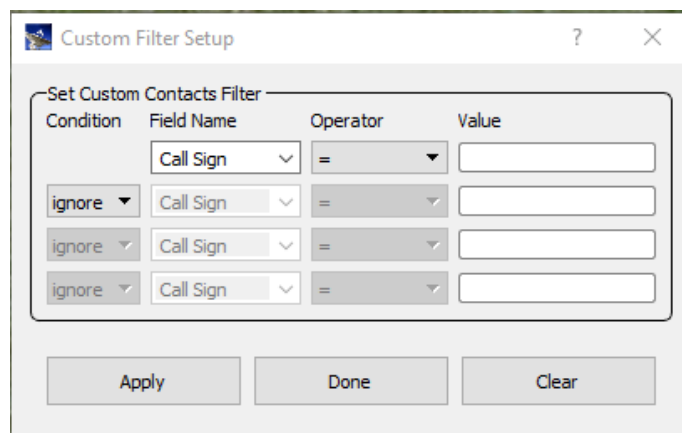

**Fig 1**

Once you are at the “Edit” drop down menu, select “Custom Contacts Filter...”. The resulting “Customer Filter Setup” dialog box, as shown in Fig 2 will pop up on your computer monitor.

The “Custom Filter Setup” dialog box will allow you to enter up to 4 different conditions to search on. So how do you use it?

After the Eyeball and Yukon Johns (KL7JR) cross country trip, I wanted to see if I had enough mobile contacts with KL7JR to submit a Bakers Dozen Award. Using the Custom Contacts Filter made determining if I had the contacts needed for the award a piece of cake! First let’s take a look at the dialog box.



**Fig 2**

The dialog box consists of four columns and four rows. The first column is “Condition”.

The condition is the logical operator that you want to use for the next three columns. Note, that you cannot set a condition on the first row. You can set a logical condition for the next three rows. To set a condition, click on the down arrow and you will be presented with a list of conditions. Select the condition you want to apply to the row. Column two is “Field Name”. Once again, click on the “down arrow” and select the field you want to use. Column three is the logic “Operator” that you wish to use in conjunction with column 4. Once again, click on the “down arrow” to select the “Operator”. Finally, column four is the “Value” you set for the field name. There is no “down arrow” associated with the “value”. In this case you type in the value to use.

For an example, I will set up the Custom Filter to search for mobile contacts with KL7JR on the 40m SSB nets. The example screenshot is on the following page. Here are the steps:

- In the first row of the Custom Dialog, set KL7JR as the call.

- In the Second row of the Custom Dialog, set the condition as “and”, the “field name” as “Band”, the Operator as “=” and the “Value” as “40m”.
- In the Third row of the Custom Dialog, set the condition as “and”, the “field name” as “Mode”, the Operator as “=”, and the “Value” as “SSB”.
- In the Fourth row of the Custom Dialog, set the condition as “and”, the “field name” as “M/P Status”, the Operator as “=”, and the “Value” as “M”.

Condition	Field Name	Operator	Value
	Call Sign	=	KL7JR
and	Band	=	40M
and	Mode	=	SSB
and	M/P Status	=	M

Buttons: Apply, Done, Clear

**Fig 3 - Completed Custom Filter Setup Dialog Box**

Once you have completed entering your query, the only thing left to do is to click on the “Apply” button. Below is a screenshot of my results:

#	Call Sign	M/P	My M/P	Date	Time (UTC)	Frequency	Mode	Band	State	Award Info	Remarks	Preferred Name	Name	DXCC	RST Rcvd	RST Sent	Sent Conf By	Rcvd Conf By	QS Int
6982	KL7JR	M		2021/07/14	04:21:51	7.192	SSB	40m	MS		VIP E...	John	John Reisenauer, Jr.	291	22	22	C	C	GIB
6960	KL7JR	M		2021/07/13	04:52:29	7.191.5	SSB	40m	AR	SC	VIPEYE	John	John F. Reisenauer, Jr.	291	22	22	C	C	GIB
6894	KL7JR	M		2021/07/10	00:34:57	7.268	SSB	40m	KS		VIPEYE	John	John F. Reisenauer, Jr.	291	22	22	C	C	GIB
6891	KL7JR	M		2021/07/10	00:34:49	7.268	SSB	40m	OK		VIPEYE	John	John F. Reisenauer, Jr.	291	22	22	C	C	GIB
6830	KL7JR	M		2021/06/07	00:47:51	7.2675	SSB	40m	ND		VIP	John	John Reisenauer, Jr.	291	22	22	C	C	GIB
6829	KL7JR	M		2021/06/07	00:47:48	7.2675	SSB	40m	MB		VIP	John	John Reisenauer, Jr.	1	22	22	C	C	GIB
6794	KL7JR	M		2021/06/03	01:05:32	7.2675	SSB	40m	MN	TRI	VIP	John	John Reisenauer, Jr.	291	22	22	C	C	GIB
6793	KL7JR	M		2021/06/03	01:05:30	7.2675	SSB	40m	SD	TRI	VIP	John	John Reisenauer, Jr.	291	22	22	C	C	GIB
6792	KL7JR	M		2021/06/03	01:05:28	7.2675	SSB	40m	IA	TRI	VIP	John	John Reisenauer, Jr.	291	22	22	C	C	GIB
6789	KL7JR	M		2021/06/02	00:26:25	7.2675	SSB	40m	MO		VIP	John	John Reisenauer, Jr.	291	55	33	C	C	GIB
6770	KL7JR	M		2021/05/31	00:28:36	7.270	SSB	40m	AL		VIP	Yukon J...	John Reisenauer, Jr.	291	55	55	C		GIB
6085	KL7JR	M		2020/11/24	05:14:46	7.192	SSB	40m	FL		OFF	John	John Reisenauer, Jr.	291	33	33	C	C	GIB
5517	KL7JR	M		2020/08/14	00:48:22	7.268	SSB	40m	AL			John	John F. Reisenauer Jr.	291	57	57	C	C	GIB
5194	KL7JR	M		2020/06/07	01:03:42	7.2675	SSB	40m	SC			John	John F. Reisenauer Jr.	291	59	59	C	C	GIB

**Fig 4 - Results of applying the Custom Filter**

Looks like I have the contacts to apply for the award. That was easy!

I hope this article was helpful.

**Steve K7QHU**

## The End - Exit with a Smile!



Tip of the Telegraph Hat to Peter, N2XTT for providing this photo!

